

Crystal Oscillator

Series 6R, Voltage Controlled Crystal Oscillator



FEATURE

- Small size as small as 20.26x12.65mm and 12.6x12.65mm
- Hybrid IC Circuit Construction
- CMOS compatible output
- All metal, hermetically sealed welded package

ELECTRICAL SPECIFICATIONS

Model type		6RF (Full Size) 6RH (Half Size)	
Frequency Range		1MHz ~ 80MHz	
Frequency Stability		±25, ±50, ±100ppm	
Operating Temperature		0-70°C, -20-70°C, -40-85°C	
Fan Out Type		HCMOS Square wave	
Load		15pF	15pF
	Voltage Voh	4.5V Minimum	3.0V Minimum
	Voltage Vol	0.4V Maximum	0.3V Maximum
	Current Ioh	-8.0mA	4.0mA
	Current Iol	8.0mA	4.0mA
	Duty Cycle	40/60 Maximum	40/60 Maximum
	Rise/Fall Time	5ns	5ns
Frequency Control		Positive Transfer Characteristic	
	Pullability	±50ppm, ±100ppm, ±150ppm, ±200ppm Minimum	
	Control Voltage	0.5Vdc to 4.5Vdc	0.3Vdc to 3.0Vdc
	Center Frequency	2.5Vdc	1.65Vdc
	Monotonic Linearity	<±15%	<±15%
	Input impedance	50Kohms Normal	50Kohms Normal
Supply Voltage		+5Vdc +/-5% or 3.3V +/-5%	+3.3V
Supply Current		60mA Max	40mA Max
Package		All metal, hermetically sealed welt package	

Crystal Oscillator

Series 6R, Voltage Controlled Crystal Oscillator



MARKING AND DIMENSIONS

Half Size VCXO

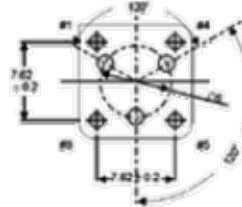
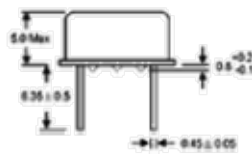
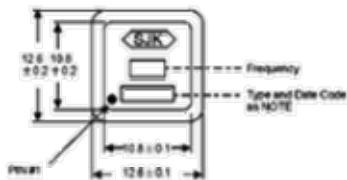

Half SIZE	
PIN	Connection
#1	Control Voltage
#4	GND
#5	Out put
#8	(+)5V DC

All units are in mm

Full Size VCXO

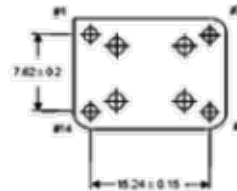
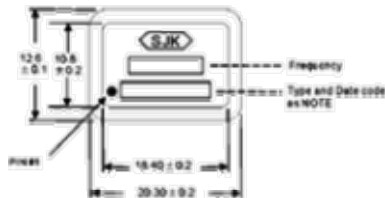

Half SIZE	
PIN	Connection
#1	Control Voltage
#7	GND
#8	Out put
#4	(+)5V DC

All units are in mm

PART NUMBER

SJK	6RF	27.000	5	25
	Model Type 6RF:full size 14pin 6RH:half size 8pin	Frequency	Supply Voltage 5:5V 3.3:3.3V	Frequency tolerance 25:±25ppm